

Conduction Pipe

Black or Galvanized

DIMENSIONS AND CHARACTERISTICS FOR WATER, GAS AND AIR CONDUCTION PIPING ASTM-A-53-A

NOMINAL SIZE		OUTSIDE DIAMETER		WALL THICKNESS		SCH.	PLAIN END WEIGHT		PIPE WEIGHT (kg)		PIPES/TON.	TEST PRESSURE ASTM-A-53-A		PACKING SYSTEM weight/bundle		
in	mm	in	mm	in	mm		lb/ft	kg/m	plain end	threaded & coupling		lb/in ²	kg/cm ²	pipes/bundle	kg	lb
1/2	13	0.840	21.3	0.109	2.77	40	0.85	1.27	8.13	8.20	123	700	50	127	1033	2277
				0.147	3.73	80	1.09	1.62	10.37	10.44	97	850	60	127	1317	2903
3/4	19	1.050	26.7	0.113	2.87	40	1.13	1.69	10.82	10.92	93	700	50	127	1374	3029
				0.154	3.91	80	1.47	2.20	14.08	14.12	71	850	60	127	1781	3926
1	25	1.315	33.4	0.133	3.38	40	1.68	2.50	16.00	16.16	63	700	50	91	1456	3210
				0.179	4.55	80	2.17	3.24	20.74	20.90	48	850	60	91	1887	4160
1 1/4	32	1.660	42.2	0.140	3.56	40	2.27	3.39	21.70	21.90	46	1200	85	91	1975	4354
				0.191	4.85	80	3.00	4.47	28.61	28.81	35	1800	127	61	1745	3847
1 1/2	38	1.900	48.3	0.145	3.68	40	2.72	4.05	25.92	26.20	39	1200	85	91	2359	5201
				0.200	5.08	80	3.63	5.41	34.62	34.90	29	1800	127	61	2112	4656
2	50	2.375	60.3	0.154	3.91	40	3.65	5.44	34.82	35.28	29	2300	162	61	2124	4683
				0.218	5.54	80	5.02	7.48	47.87	48.34	21	2500	176	32	1532	3377
2 1/2	64	2.875	73.0	0.203	5.16	40	5.79	8.63	55.23	56.28	18	2500	176	37	2041	4500
				0.160	4.06	NX	4.64	6.91	44.23	45.35	22	1950	137	37	1637	3609
3	76	3.500	88.9	0.216	5.49	40	7.58	11.29	72.26	73.78	14	2220	156	19	1373	3027
				0.170	4.32	NX	6.05	9.01	57.66	59.19	17	1930	136	19	1096	2416
4	102	4.500	114.3	0.237	6.02	40	10.79	16.07	102.85	104.82	10	1900	134	19	1953	4306
				0.188	4.78	NX	8.66	12.91	82.62	84.48	12	1500	105	19	1568	3457

Length: 21 ft.

THREADING BASIC DATA

PIPE			THREAD							COUPLING						
NOMINAL SIZE	OUTSIDE DIAMETER D		THREADS PER INCH.	END OF PIPE TO HAND TIGHT PLANE L1		EFFECTIVE LENGTH L2		TOTAL LENGTH L4		PITCH DIAMETER AT HAND TIGHT PLANE. E1		OUTSIDE DIAMETER W		LENGTH NL		HAND TIGHT STAND-OFF (No. OF THREADS).
	mm	in		mm	in	mm	in	mm	in	mm	in	mm	in	mm	in	
1/2	21.34	(0.840)	14	8.13	(0.320)	13.56	(0.534)	19.85	(0.782)	19.77	(0.778)	27.00	(1.063)	39.69	1 9/16	5
3/4	26.67	(1.050)	14	8.61	(0.339)	13.86	(0.546)	20.15	(0.794)	25.12	(0.989)	33.35	(1.313)	41.28	1 5/8	5
1	33.40	(1.315)	11 1/2	10.16	(0.400)	17.34	(0.683)	25.01	(0.985)	31.46	(1.239)	40.03	(1.576)	50.80	2	5
1 1/4	42.16	(1.660)	11 1/2	10.67	(0.420)	17.95	(0.707)	25.62	(1.009)	40.22	(1.583)	48.26	(1.500)	52.34	2 1/16	5
1 1/2	48.26	(1.900)	11 1/2	10.67	(0.420)	18.38	(0.724)	26.04	(1.025)	46.29	(1.822)	55.88	(2.200)	52.34	2 1/16	5 1/2
2	60.33	(2.375)	11 1/2	11.07	(0.436)	19.22	(0.757)	26.88	(1.058)	58.33	(2.296)	69.85	(2.750)	53.97	2 1/8	5 1/2
2 1/2	73.03	(2.875)	8	17.32	(0.682)	28.89	(1.138)	39.91	(1.571)	70.16	(2.762)	82.55	(3.250)	79.38	3 1/8	5 1/2
3	88.90	(3.500)	8	19.46	(0.766)	30.48	(1.200)	41.50	(1.634)	86.07	(3.389)	101.60	(4.000)	82.55	3 1/4	5 1/2
4	114.39	(4.500)	8	21.44	(0.844)	33.02	(1.300)	44.04	(1.733)	111.43	(4.387)	127.00	(5.000)	88.90	3 1/2	5

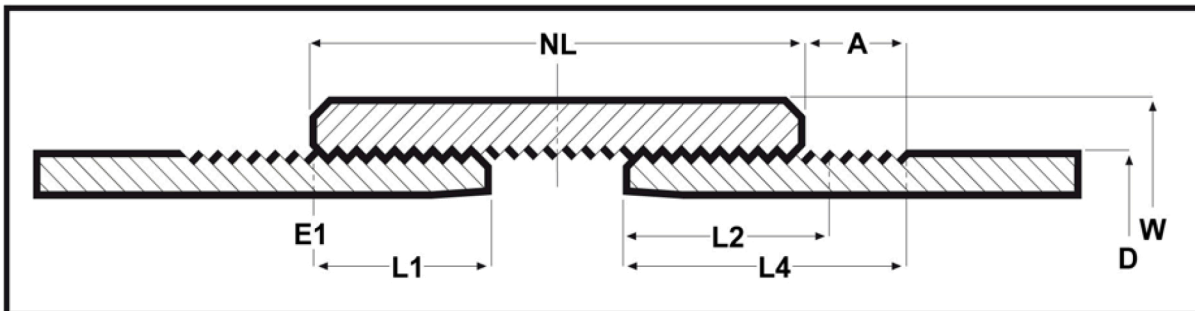

Thread graph Specifications' nomenclature corresponds to the above tables.

Conduction Pipe

Black or Galvanized

CHEMICAL AND PHYSICAL REQUIREMENTS FOR CONDUCTION PIPING STANDARDS

REQUIREMENTS	ASTM A-53-A NMX-B-177
Yield strength min. kg./cm. ² (lb./pulg. ²) / (PSI)	3,400 (48,000)
Ultimate tensile strength, min. kg./cm. ² (lb./pulg. ²) / (PSI)	2,109 (30,000)
% E en 2"	$\frac{A 0.2}{U 0.9}$
% C X 100	25
% Mn X 100	95
% P X 1000	50
% S X 1000	60
% Cu X 100	-

A = Area
625.000

U= Last stress effort.
 $\frac{A 0.2}{U 0.9}$

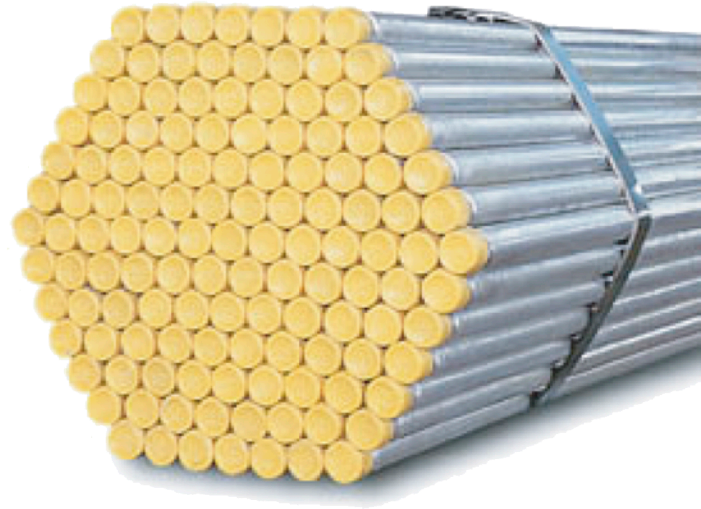

COUPLING PIPES ASTM A - 53 - A

NOMINAL SIZE in	OUTSIDE DIAMETER in	INSIDE DIAMETER in	WALL THICKNESS in	H&D TEST PRESSURE kg/cm ²	WEIGHT kg/m
1/2	1.050	0.715	0.172	70	2.43
3/4	1.315	0.915	0.205	70	3.45
1	1.576	1.150	0.210	70	4.68
1 1/4	1.900	1.480	0.215	100	6.41
1 1/2	2.200	1.721	0.245	100	7.94
2	2.750	2.199	0.280	100	11.85

STANDARDS

SPECIFICATIONS		DESCRIPTION	DIMENSIONS				USAGE
U.S.A. ASTM	MEXICO NMX		DIAMETER		THICKNESS		
			MIN.	MAX.	MIN.	MAX.	
A-53-A	B-177 TYPE E GRADE A	Carbon steel, black and hot dipped galvanized seamed pipes for common usage.	1/2"	4"	SCH. 40 0.109"	0.237"	Liquid, air and vapor conduction for jobs that require bending and rim work.
			1/2"	2"	COUPLING 0.172"	0.291"	
			1/2"	2"	SCH. 80 0.147"	0.218"	
			2 1/2"	4"	NORM X 0.160"	0.188"	